

95% PRE-LEASED



PARKTON WELLNESS CENTRE

842 PORTLAND STREET, DARTMOUTH

Brand New Space with Massive Visibility on a Main Arterial Route

- Approximately 1,350 sf of ground floor retail / profile office space
- Surrounded by both established and growing residential neighbourhoods
- Available immediately for tenant construction

This opportunity includes approximately 1,350 sf of Class A, street level commercial end cap space at the high-traffic corner of Portland Street and Portland Hills Drive. This brand new, superior quality build offers a contemporary tilt-up design and is 95% pre-leased to strong-covenant tenants in the health & wellness sector.

Property features include on-site surface parking for visitors and employees, large storefront windows facing the parking lot and highly visible signage opportunities. Amenities in the area are plentiful in all directions, a major transit terminal is steps away, well-established and desirable residential neighbourhoods surround the property, and an 80+ unit luxury apartment building is underway next door.

partnersglobal.com

FOR LEASE

By negotiation

Erin Crosby

M (902) 877-1849

erin@partnersglobal.com



Parkton Wellness Centre | 842 Portland Street, Dartmouth



LISTING ID	10234
ADDRESS	842 Portland Street, Dartmouth, Nova Scotia
LOCATION	Dartmouth East - Portland Street Corridor
BUILDING NAME	Parkton Wellness Centre
TOTAL BUILDING SIZE	+/- 27,500 sf
SIZE AVAILABLE	+/- 1,350 sf
FLOOR LOCATION	Ground of 2
PARKING	Free on-site paved surface parking (3 stalls per 1,000 sf)
AVAILABILITY	Ready for tenant fit-up immediately
BASE RENT	By negotiation
ADDITIONAL RENT	\$11.50 psf (2021 estimate)
TRAFFIC VOLUME	Over 40,000 vehicles daily

Parkton Wellness Centre | 842 Portland Street, Dartmouth

AVAILABLE SPACE

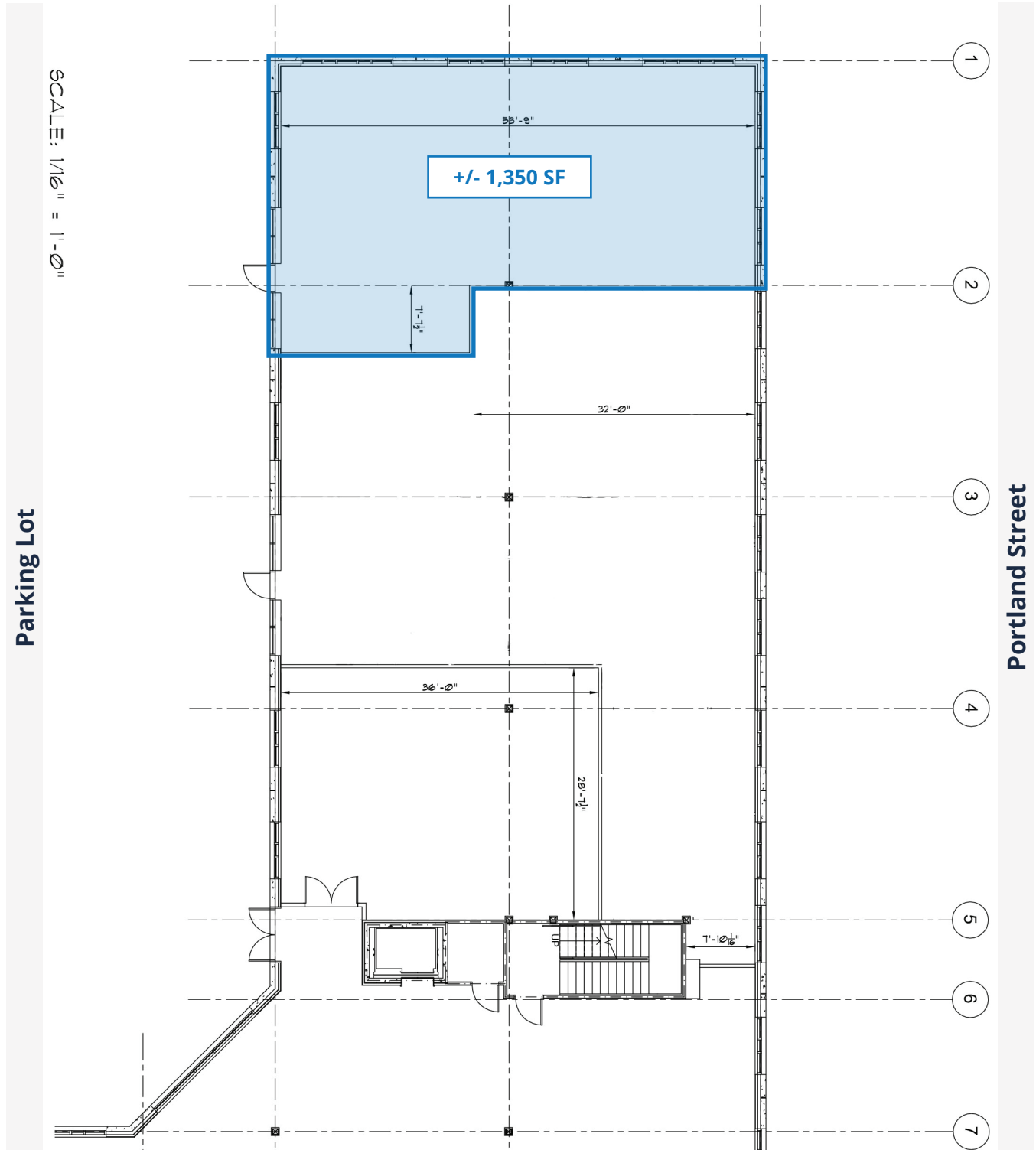



DOWNTOWN HALIFAX

DOWNTOWN DARTMOUTH



HWY-111



BAKER DR

PORTLAND ST



Luxury apartment building under construction



For more information please contact:

Erin Crosby
M (902) 877-1849
erin@partnersglobal.com

Partners Global Corporate Real Estate (Partners Global) and its agents and affiliates do not warrant, represent or guarantee the accuracy, completeness or validity of the information provided herein. Parties interested in the property are to conduct their own independent investigations to determine the suitability of the property for their intended use and are strongly urged to discuss the property with their professional advisors. Partners Global expressly disclaims any liability arising out of any errors and omissions in the information. Prospective clients should not confine themselves to the contents but should make their own enquiries to satisfy themselves in all respects. Partners Global will not accept any responsibility should any details prove to be incomplete or incorrect.

partnersglobal.com

