

FOR LEASE



72 PORTLAND STREET DOWNTOWN DARTMOUTH

High Profile Commercial Space in the Heart of Downtown Dartmouth

- 4,011 square feet of prime ground floor retail space
- Convenient downtown location with great exposure
- Available immediately

This opportunity represents approximately 4,000 sf of ground floor retail, restaurant, or profile office space situated in the highly desirable, rapidly growing, and vibrant neighbourhood of Downtown Dartmouth. 72 Portland Street is centrally located with excellent transit access (both bus and ferry) and is steps away from numerous popular boutique shops, local restaurants, cafés, and other convenient neighbourhood amenities.

This space offers fantastic storefront windows, excellent signage opportunities, and high ceilings within. Formerly utilised as a pharmacy, the space is currently configured with retail to the front, storage to the rear, and office / exam rooms to one side, but could be converted to full retail, or even a café / restaurant!

partnersglobal.com

FOR LEASE

Starting at \$29.00 psf (semi-gross)

Geof Ralph

D (902) 444-3006

M (902) 877-9324

geof@partnersglobal.com



72 Portland Street | Downtown Dartmouth, NS



DOWNTOWN DARTMOUTH

- Over the past few years, downtown Dartmouth has grown into a vibrant community with top-notch cafes, restaurants, shops, galleries, and more.
- Small-town feel, but an immense amount of creativity and a strong entrepreneurial spirit.

72 PORTLAND STREET

- Purpose built in the 1950's for famous retail company, Woolworth, who remained as a tenant until the 1990's.
- The property has a commanding presence at the corner of Portland and King Streets.
- The building's current configuration provides flexibility in leasing options.

LISTING ID	10206
ADDRESS	72 Portland Street, Dartmouth, Nova Scotia
LOCATION	Downtown
PROPERTY TYPE	Commercial (office / retail)
ZONING	DB - Downtown Business District Zone
FLOOR LOCATION	Ground floor
SIZE AVAILABLE	4,011 sf
AVAILABILITY	Immediately
PARKING	Up to five (5) on-site paid surface stalls
BASE RENT	Starting at \$29.00 psf (semi-gross)
ADDITIONALS	Utilities and cleaning

72 Portland Street | Downtown Dartmouth, NS

FLOOR PLAN

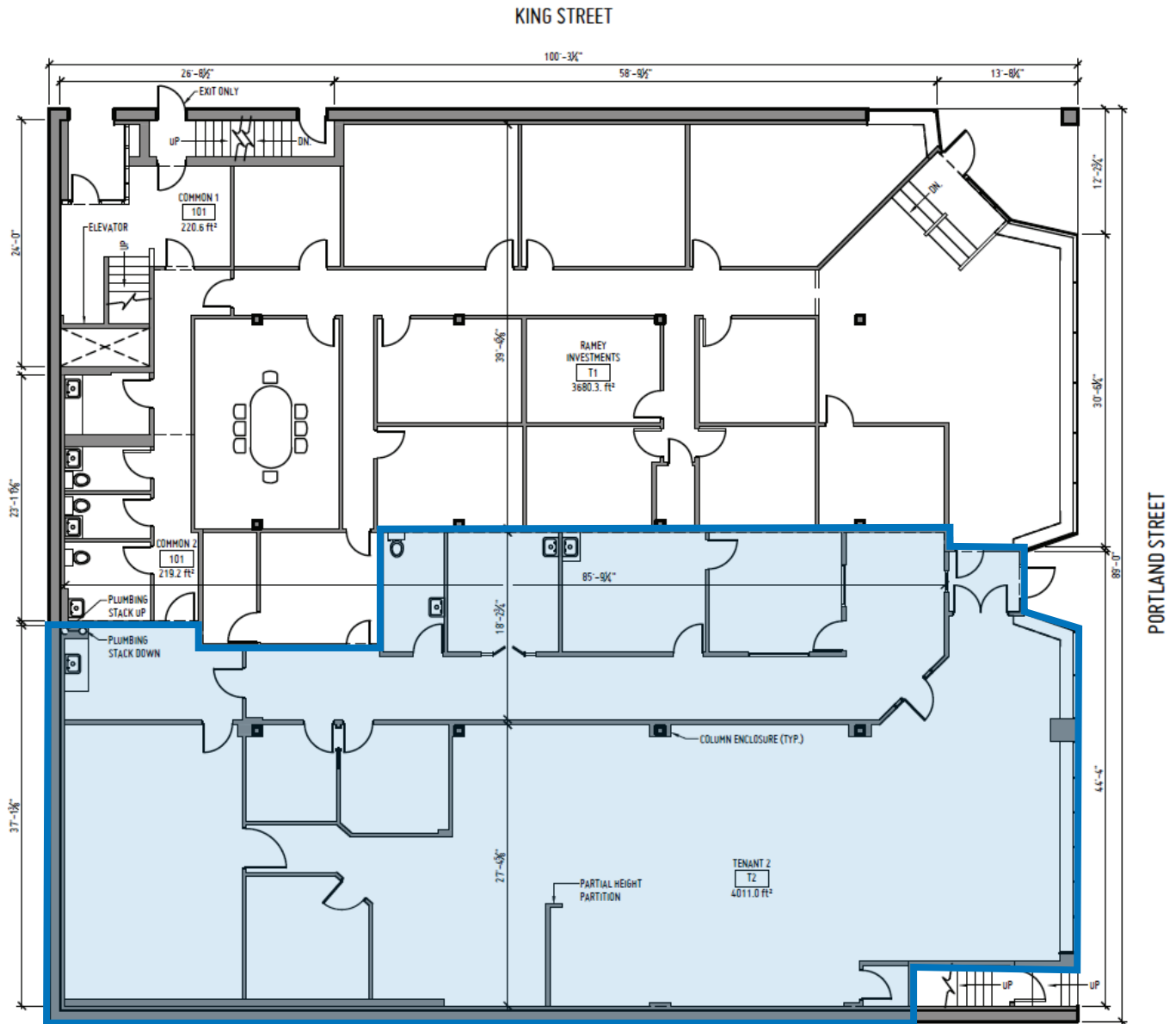



For more information please contact:

Geof Ralph

D (902) 444-3006

M (902) 877-9324

geof@partnersglobal.com

Partners Global Corporate Real Estate (Partners Global) and its agents and affiliates do not warrant, represent or guarantee the accuracy, completeness or validity of the information provided herein. Parties interested in the property are to conduct their own independent investigations to determine the suitability of the property for their intended use and are strongly urged to discuss the property with their professional advisors. Partners Global expressly disclaims any liability arising out of any errors and omissions in the information. Prospective clients should not confine themselves to the contents but should make their own enquiries to satisfy themselves in all respects. Partners Global will not accept any responsibility should any details prove to be incomplete or incorrect.

partnersglobal.com

