

FOR LEASE

1657 BEDFORD ROW DOWNTOWN HALIFAX, NOVA SCOTIA

Exceptional office space for lease
in vibrant downtown Halifax



Geof Ralph

- 📞 (902) 444-4004
- 📠 (902) 877-9324
- ✉️ geof@partnersglobal.com

partnersglobal.com



Exceptional office space for lease in vibrant downtown Halifax

Nestled on a picturesque street in the heart of downtown Halifax, 1657 Bedford Row offers urban convenience and effortless connectivity. The property is surrounded by an array of amenities, including shops, restaurants, hotels, and banks, while also being mere steps away from the Halifax Ferry Terminal and the iconic Queens Marque.

Two suites are available for lease at 1657 Bedford Row; Suite One features 3,040 sq. ft. of built-out office space, while Suite Two offers 3,474 sq. ft. of raw space and is ready for customization. The suites can be leased individually or combined. Both located on the second floor, the suites are thoughtfully designed with perimeter private offices and meeting rooms with ample natural lighting throughout.

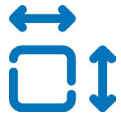

3,040 sq. ft.
to 6,514 sq. ft.



Downtown
Location



Ample Natural
Light

LISTING ID	10372
ADDRESS	1657 Bedford Row
LOCATION	Downtown Halifax
PROPERTY TYPE	Office
SIZE AVAILABLE	Suite 1: 3,040 sq. ft. Suite 2: 3,474 sq. ft. Combined: 6,514 sq. ft.
FLOOR LOCATION	Second level
PARKING	Four parking spaces available at market rates
TERM	1-3 year term
NET RENT	By negotiation (call a listing agent for details)
ADDITIONAL RENT	\$7.00 psf plus utilities and interior cleaning



1657 BEDFORD ROW | DOWNTOWN HALIFAX

Floor Plan

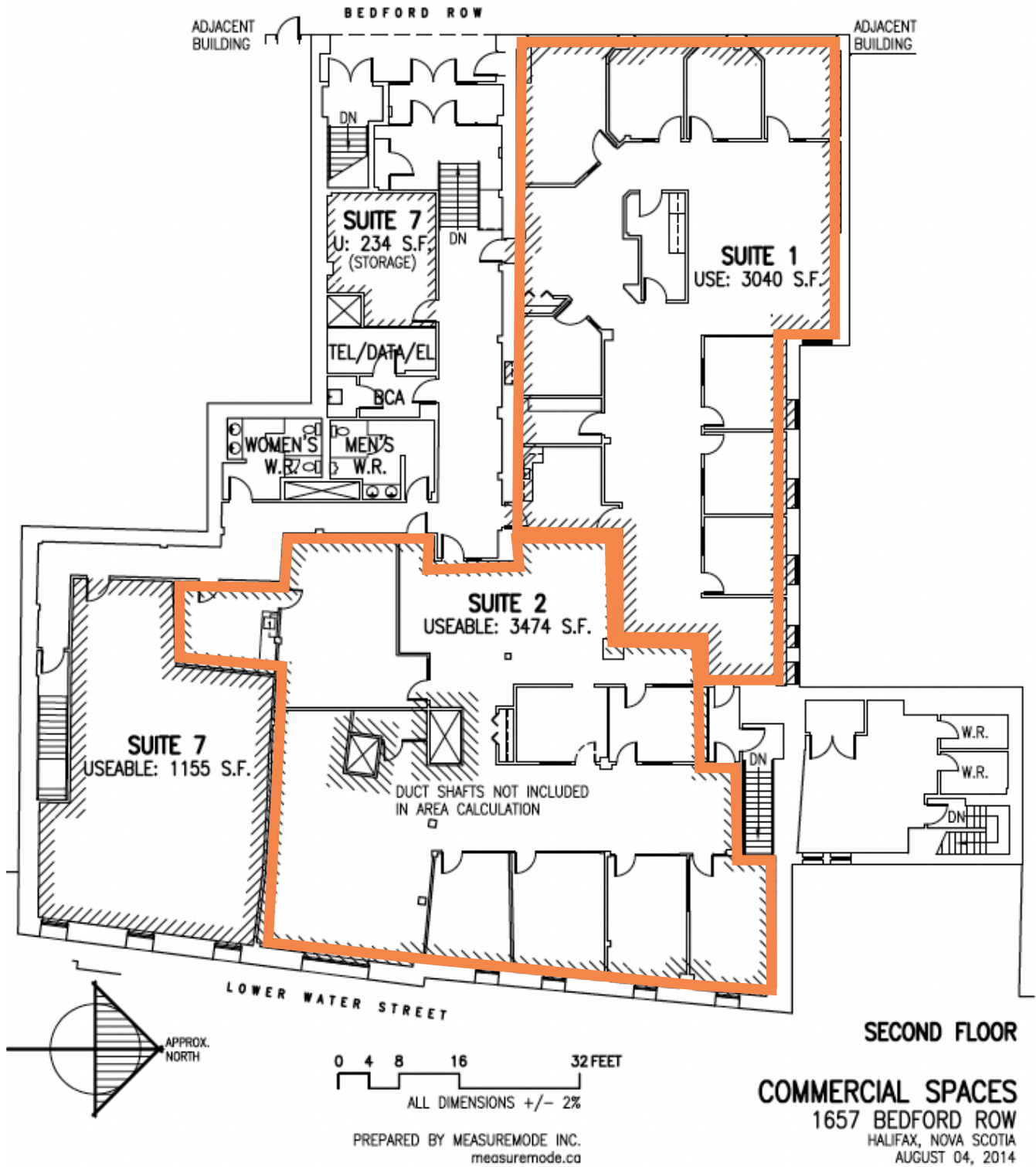



RECEPTION AREA



HALLWAY



MEETING ROOM



OPEN WORKSPACE



PRIVATE OFFICE

- 1 Scotia Square Mall
- 2 Halifax Ferry Terminal
- 3 Queens Marque District
- 4 Scotiabank Centre
- 5 Halifax Convention Centre

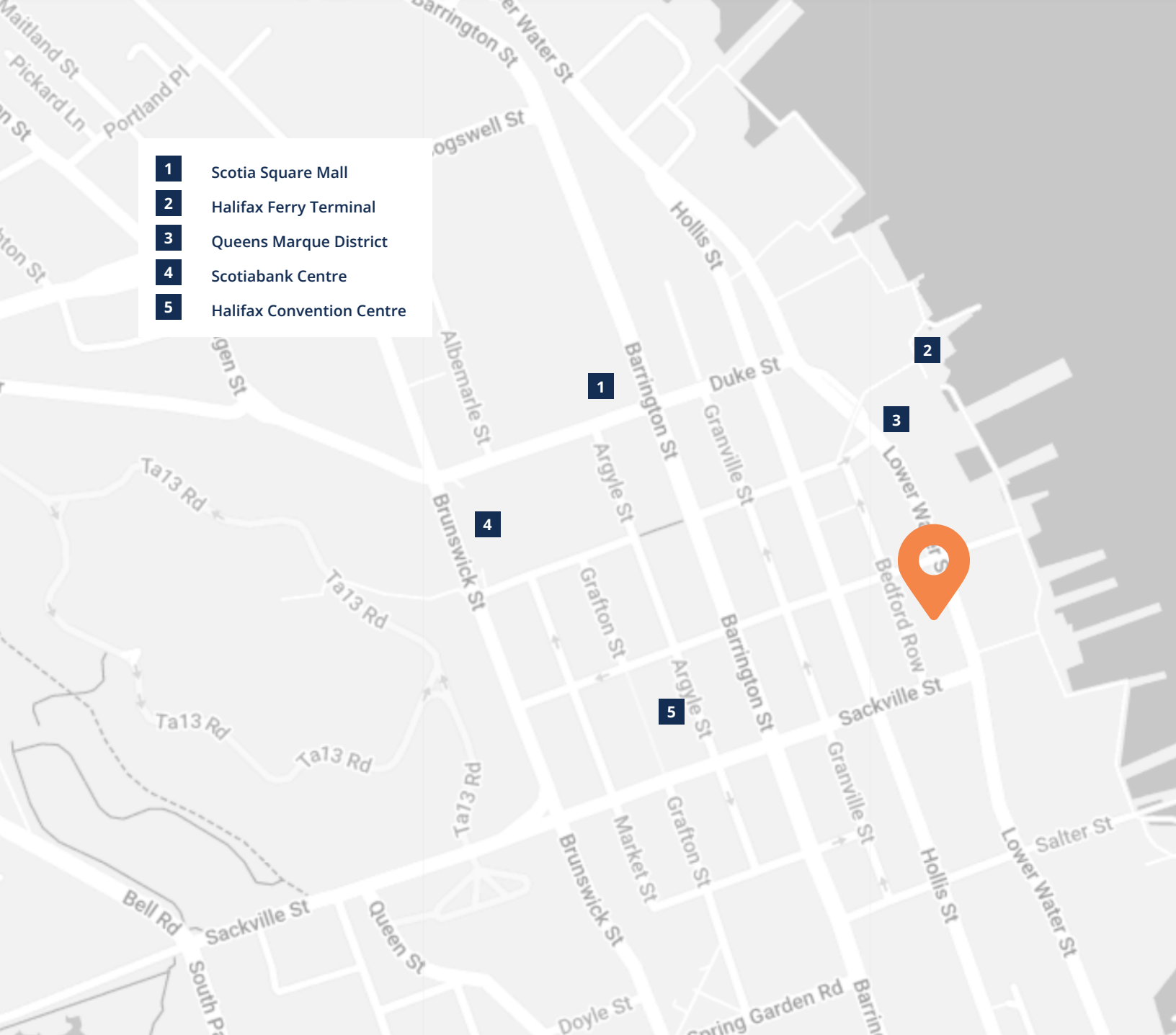

Geof Ralph

- 📞 (902) 444-3006
- 📱 (902) 877-9324
- ✉️ geof@partnersglobal.com

partnersglobal.com

Partners Global Corporate Real Estate (Partners Global) and its agents and affiliates do not warrant, represent or guarantee the accuracy, completeness or validity of the information provided herein. Parties interested in the property are to conduct their own independent investigations to determine the suitability of the property for their intended use and are strongly urged to discuss the property with their professional advisors. Partners Global expressly disclaims any liability arising out of any errors and omissions in the information. Prospective clients should not confine themselves to the contents but should make their own enquiries to satisfy themselves in all respects. Partners Global will not accept any responsibility should any details prove to be incomplete or incorrect.

