

250 BROWNLOW

CORNER UNIT | 5,890 SQ. FT.



CITY OF LAKES BUSINESS PARK

PROPERTY HIGHLIGHTS

LISTING ID	10385
ADDRESS	250 Brownlow
LOCATION	City of Lake Business Park
PROPERTY TYPE	Office / Commercial
BUILDING SIZE	54,228 sq. ft.
SPACE AVAILABLE	5,888 sq. ft.
PARKING	Ample, on-site parking
NET RENT	By negotiation
ADDITIONAL RENT	\$7.75 psf (2025)



PROPERTY OVERVIEW

- Excellent highway visibility
- Versatile floor plan
- Located on public transit routes
- High profile signage opportunities
- Back-up generator
- Building tenants include CSAP, Trane, and International Paint
- Monitored fire and security alarm systems
- Low operating costs
- General Industrial (I-2) Zoning
- Ample on-site parking
- Professionally managed property
- Surrounded by a vast array of local and commercial amenities

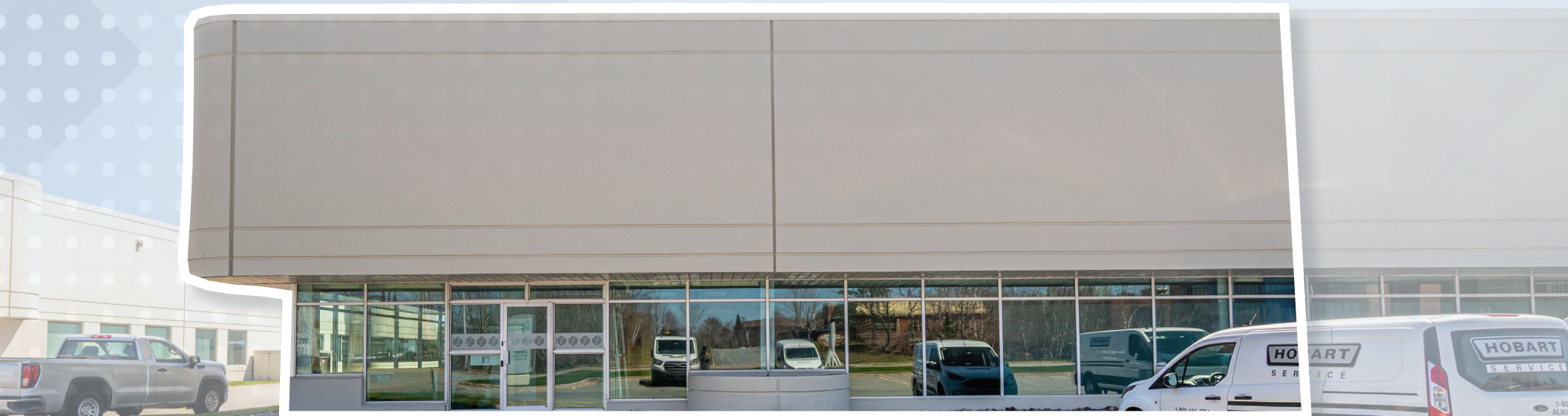

FLOOR PLAN

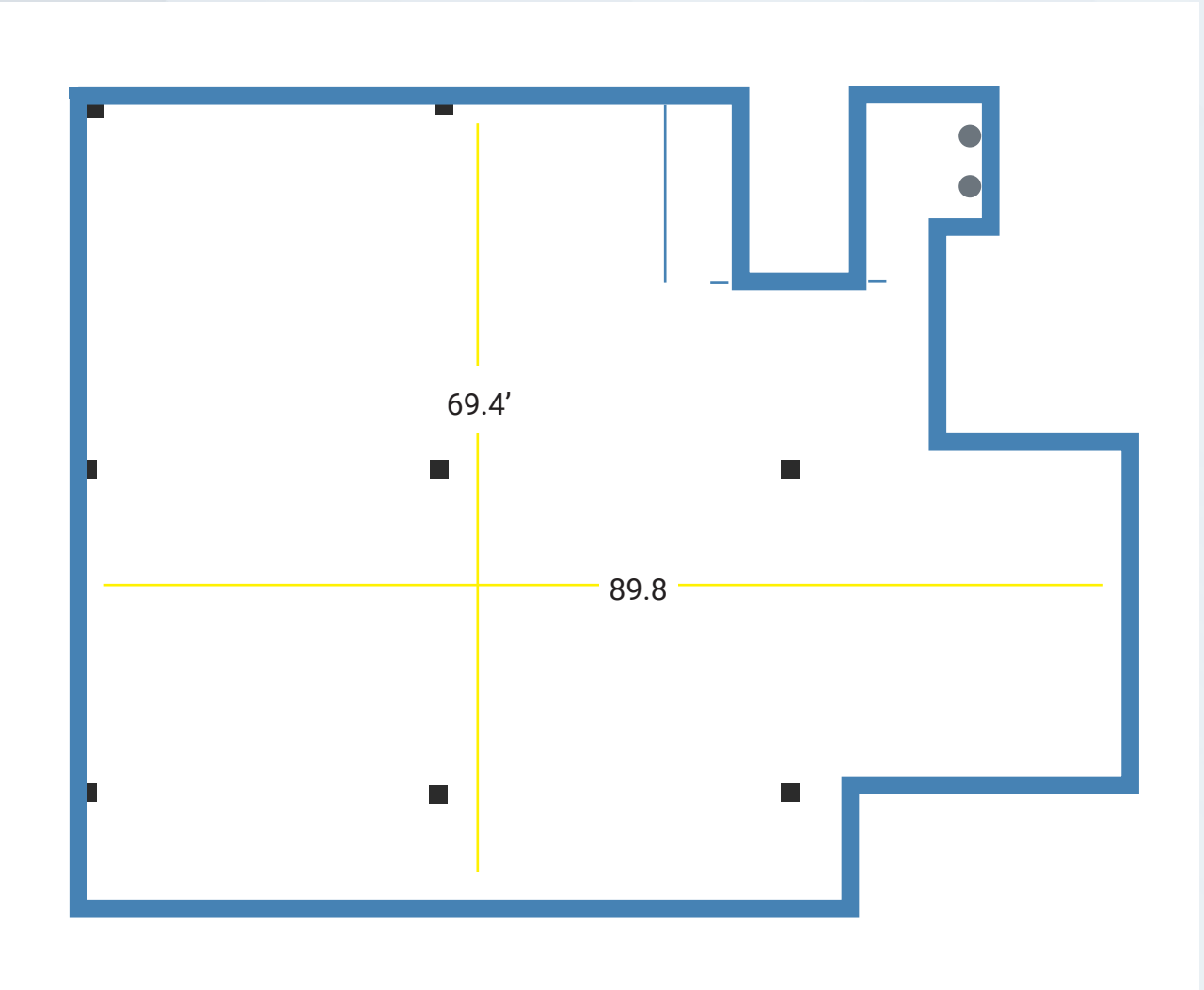



5 Minutes
to the Highway 107

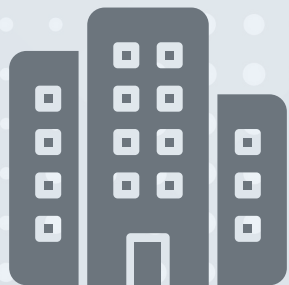

15 Minutes
to downtown Halifax



20 Minutes
to Halifax Stanfield
International Airport

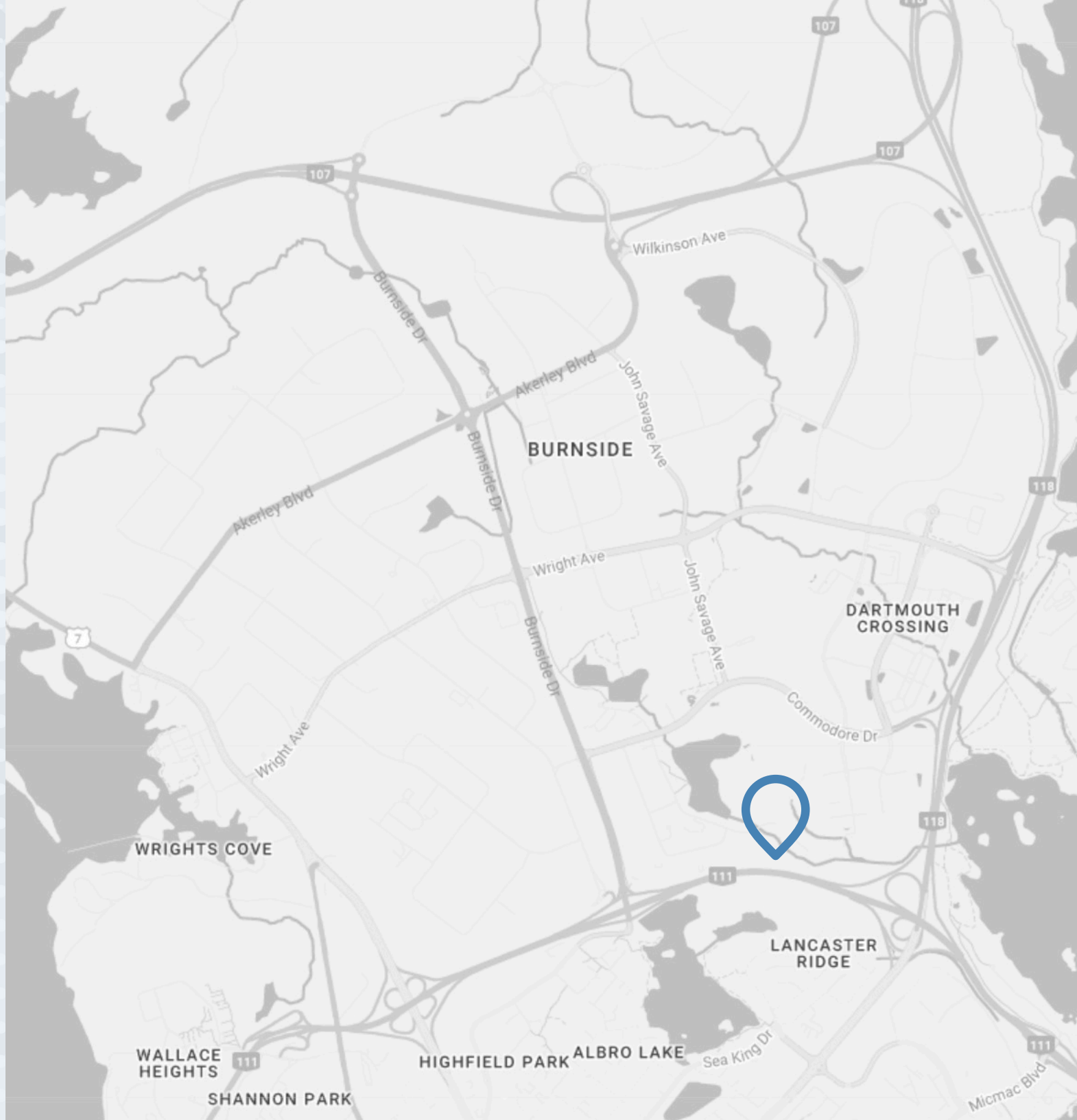





CONTACT

Geof Ralph

(902) 877-9324

geof@partnersglobal.com

partnersglobal.com

Partners Global Corporate Real Estate (Partners Global) and its agents and affiliates do not warrant, represent or guarantee the accuracy, completeness or validity of the information provided herein. Parties interested in the property are to conduct their own independent investigations to determine the suitability of the property for their intended use and are strongly urged to discuss the property with their professional advisors. Partners Global expressly disclaims any liability arising out of any errors and omissions in the information. Prospective clients should not confine themselves to the contents but should make their own enquiries to satisfy themselves in all respects. Partners Global will not accept any responsibility should any details prove to be incomplete or incorrect.

[For more info, click here.](#)